

ELEVATION (COUNTERWEIGHT WITHOUT SAFETY)

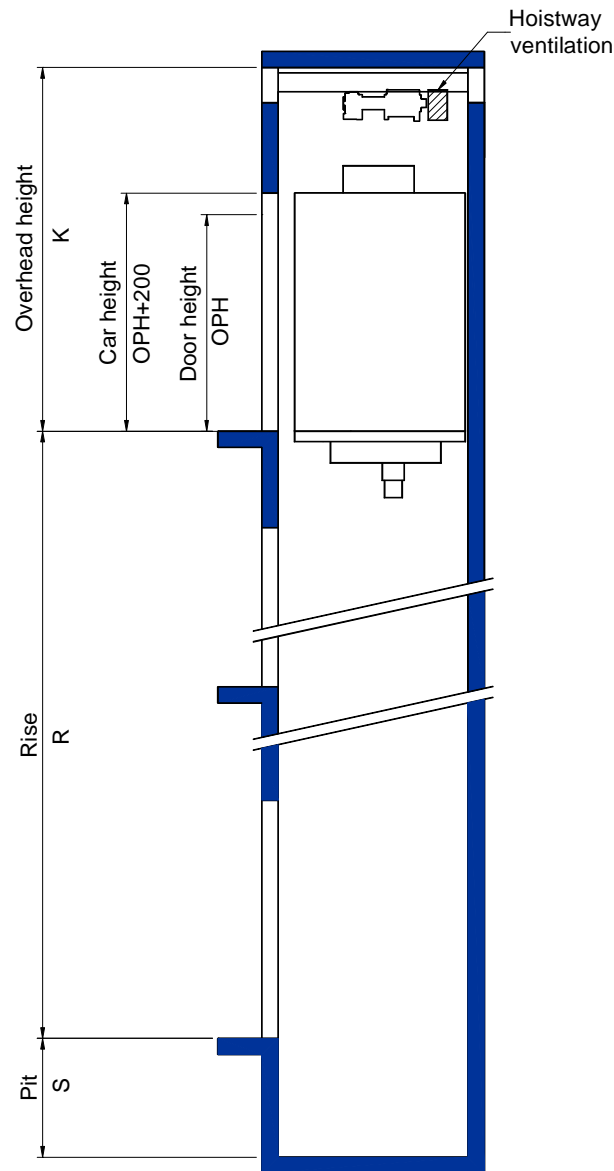

MACHINE MOUNTING

PLAN VIEW

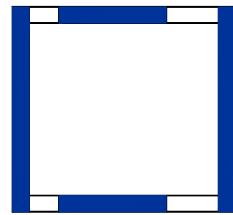

Machinery on the right

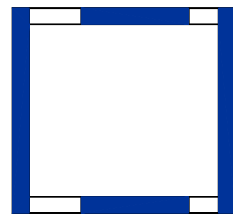

Machinery on the left

Duplex and triplex car arrangements are available

DOOR MOUNTING

IN HOISTWAY

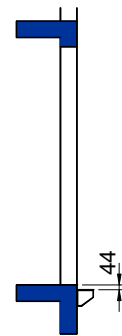

ON LANDING

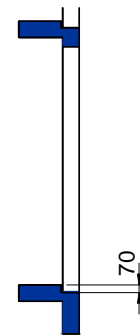

100 TLD/CLD

| Speed (m/s) | S (mm) | K (mm) | |
|-------------|--------|----------|----------|
| | | OPH 2000 | OPH 2100 |
| 1.0 | 1120* | 3380 | 3480 |
| 1.6 | 1400 | 3600 | 3700 |

* If Rise > 40 m consult OTIS

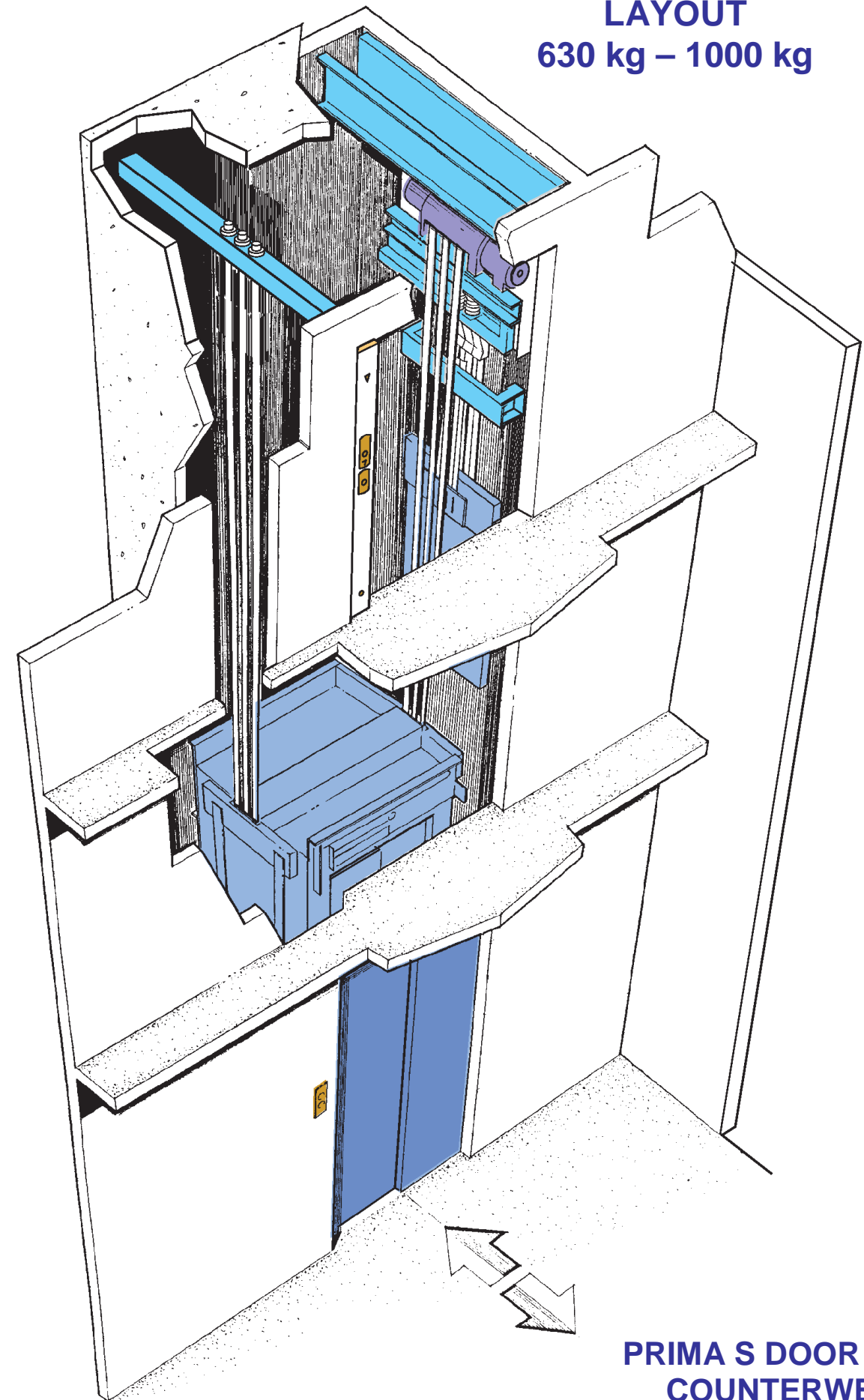

Machine room less

Gearless machine

Permanent magnet motor

Coated steel belts

**PRIMA S DOOR EN81-58
COUNTERWEIGHT
WITHOUT SAFETY**

OTIS

www.otis.com

FAA29100B/07_CTL (09-12)

© Otis Elevator Company 2009, All rights reserved

DIMENSIONS (COUNTERWEIGHT WITHOUT SAFETY) – PRIMA S

ONE ENTRANCE CAR (1#)

Side opening (TLD) right hand

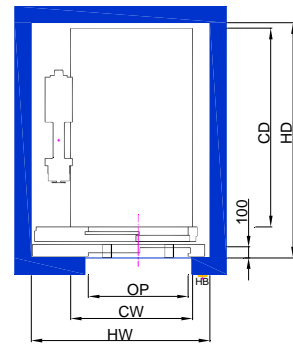

Center opening (CLD)

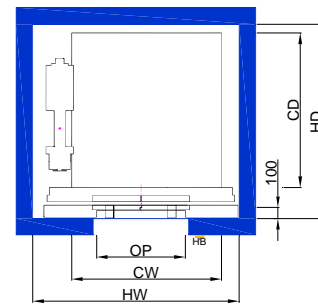

TWO ENTRANCE CAR (2#)

Side opening (TLD)

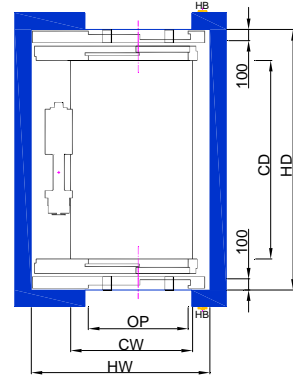

Center opening (CLD)

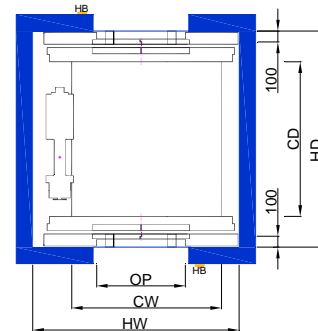

SIDE OPENING (TLD) RIGHT HAND
(opposite hand is available)

E&I panel landing

TYFAC : MRF 150

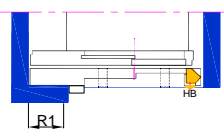

Other landings

Small Frame or No Frame
TYFAC : SF or NF

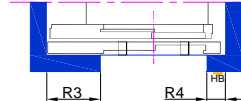

Medium REDUCED Frame
TYFAC : MRF 100 & MRF 150

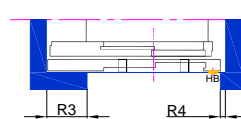

CENTER OPENING (CLD)

Small Frame or No Frame
TYFAC : SF or NF

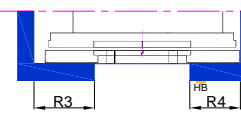

Medium REDUCED Frame
TYFAC : MRF 100 & MRF 150

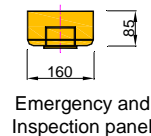
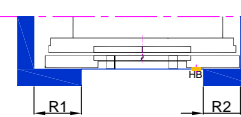

| Load and passenger number | Rated speed v (m/s) | Car internal sizes | | Door type | Door opening OP (mm) | Hoistway dimensions | | |
|---------------------------------|---------------------|--------------------|-------------------|-----------|----------------------|------------------------|------------------------|------|
| | | car width CW (mm) | car depth CD (mm) | | | Hoistway width HW (mm) | Hoistway depth HD (mm) | |
| | | | | | | | 1 # | 2 # |
| 630 kg 8 pers. deep car | 1.00 and 1.60 | 1100 | 1400 | TLD | 800 | 1600 | 1755 | 1970 |
| | | | | | 900 | | | |
| 800 kg 10 pers. wide car | 1.00 and 1.60 | 1350 | 1400 | CLD | 800 | 1800 | 1760 | 1980 |
| | | | | | 900 | | | |
| 1000 kg 13 pers. deep car | 1.00 and 1.60 | 1100 | 2100 | TLD | 800 | 1600 | 2455 | 2670 |
| | | | | | 900 | | | |
| 1000 kg 13 pers. wide car | 1.00 and 1.60 | 1600 | 1400 | CLD | 800 | 2150 | 1790 | 1980 |
| | | | | | 900 | | | |

| Number of passenger | Door type | Door opening (mm) | Machine location | Return walls | | | | | | | | | |
|----------------------------|-----------|-------------------|------------------|-------------------|-----------------|----------------|---------|---------|-----|---------|---------|-----|-----|
| | | | | E&I panel landing | | Other landings | | | | R4 (mm) | | | |
| | | | | R1 (mm) | R2 (mm) | R3 (mm) | | R4 (mm) | | R4 (mm) | | | |
| | | | | ALWAYS MOUNTING | ALWAYS MOUNTING | MRF 150 | MRF 100 | SF | NF | MRF 150 | MRF 100 | SF | NF |
| 8 pers. and 13 pers. | TLD | 800 | Left | MRF 150 | MRF 150 | 325 | 375 | 455 | 475 | 115 | 165 | 245 | 265 |
| | | | | | | 115 | 165 | 245 | 265 | 325 | 375 | 455 | 475 |
| | | 900 | Left | R1=R3 | R2=R4 | 355 | 405 | 485 | 505 | 35 | 85 | 165 | 185 |
| | | | | | | 35 | 85 | 165 | 185 | 355 | 405 | 485 | 505 |
| 13 pers. | CLD | 800 | Left | NF or SF | NF or SF | - | 45 | 125 | 145 | 345 | 395 | 475 | 495 |
| | | | | | | 320 | 370 | 450 | 470 | 320 | 370 | 450 | 470 |
| | | 900 | Left | R1=R3 | R2=R4 | 320 | 370 | 450 | 470 | 320 | 370 | 450 | 470 |
| | | | | | | 365 | 415 | 495 | 515 | 365 | 415 | 495 | 515 |
| | | | | | | 365 | 415 | 495 | 515 | 365 | 415 | 495 | 515 |

| Number of passenger | Door type | Door opening (mm) | Machine location | Return walls | | | | | | | | | |
|---------------------|-----------|-------------------|------------------|-------------------|-----------------|----------------|---------|---------|-----|---------|---------|-----|-----|
| | | | | E&I panel landing | | Other landings | | | | R4 (mm) | | | |
| | | | | R1 (mm) | R2 (mm) | R3 (mm) | | R4 (mm) | | R4 (mm) | | | |
| | | | | ALWAYS MOUNTING | ALWAYS MOUNTING | MRF 150 | MRF 100 | SF | NF | MRF 150 | MRF 100 | SF | NF |
| 10 pers. | TLD | 900 | Left | MRF 150 | MRF 150 | 595 | 645 | 725 | 745 | 45 | 95 | 175 | 195 |
| | | | | | | 45 | 95 | 175 | 195 | 595 | 645 | 725 | 745 |
| | CLD | 800 | Left | NF or SF | NF or SF | 415 | 465 | 545 | 565 | 325 | 375 | 455 | 475 |
| | | | | | | 325 | 375 | 455 | 475 | 415 | 465 | 545 | 565 |
| 13 pers. | CLD | 900 | Left | R1=R3 | R2=R4 | 375 | 425 | 505 | 525 | 365 | 415 | 495 | 515 |
| | | | | | | 365 | 415 | 495 | 515 | 375 | 425 | 505 | 525 |
| | | | | | | 525 | 575 | 655 | 675 | 365 | 415 | 495 | 515 |
| | | | | | | 365 | 415 | 495 | 515 | 525 | 575 | 655 | 675 |

DEFINITIONS

| Identifier | Definition | Identifier | Definition | Identifier | Definition |
|------------|----------------------|------------|---|------------|-------------------------|
| CD | Car internal depth | MRF100 | Medium Reduced Frame (100 mm wide column) | OP | Car opening width |
| CH | Car internal height | MRF150 | Medium Reduced Frame (150 mm wide column) | OPH | Car opening height |
| CLD | Central landing door | | | R | Rise |
| CW | Car internal width | NF | No Frame | S | Pit depth |
| HD | Hoistway depth | SF | Small Frame | TLD | Telescopic landing door |
| HW | Hoistway width | | | 1# | One entrance car |
| K | Overhead height | | | 2# | Two entrance car |
| | | | | TYFAC | Type of façade |

OTIS reserves the right to change any part of this specification without prior notice.